

MONCADA 1963 DOLCE VITA



DOLCE VITA

Length: 22.35 metres (73' 4")

Beam: 5.45 metres (17' 11")

Draft: 1.0 metres (3' 3")

Number of Guests: 8

Number of Crew: 2

Built: 2001

Refit: 2018

Builder: Astondoa

Flag: Spanish

Hull Construction: GRP

Hull Configuration: Planing hull

Air conditioning

Dolce Vita, a Astondoa 72, is a 22 meter motor yacht with flybridge. Her excellent seaworthiness and spacious areas have made this yacht Astondoa Shipyard's best-selling model. She can accommodate up to 10 people during the day and 8 people at night in four en suite cabins made with exclusive materials. Dolce Vita offers comfort in an elegant setting, she has always been given an excellent level of maintenance, and a full refit was carried out in 2012, including fabrics, indoor and outdoor Hi-Fi, TV, home cinema, etc., making her look like brand new. Dolce Vita has a wide range of water toys on board, including a tender and a jet ski. In summer her home port is Ibiza on the Balearic Islands and she is also available for

charter in Mallorca and Menorca. She is available to charter in other areas upon request. The crew consists of an excellent captain and a professional stewardess.

KEY FEATURES

- 1** DOLCE VITA has an annual refit every winter
- 2** Lots of toys including a jet ski
- 3** Captain Victor Mur has been on board for 6 years, so he knows the yacht and the Balearic islands like the back of his hand



DOLCE VITA - At anchor



DOLCE VITA - At anchor



DOLCE VITA - Flybridge



DOLCE VITA - Sunbathing area



DOLCE VITA - Twin cabin n°2



DOLCE VITA - Twin cabin n°1



DOLCE VITA - VIP cabin



DOLCE VITA - Master cabin bathroom



DOLCE VITA - Aft deck table



DOLCE VITA - Aft deck table



DOLCE VITA - Toys



DOLCE VITA - Main salon



DOLCE VITA - Main salon



DOLCE VITA - Main salon table n°1



DOLCE VITA - Main salon table n°2



DOLCE VITA - Master cabin



DOLCE VITA - Layout

SPECIFICATIONS

ACCOMMODATION

Number of Guests: 8

Number of Cabins: 4

Cabin Configuration: 2 Double, 2 Twin

Bed Configuration: 2 King, 4 Single

EQUIPMENT

Engines: 2 x MAN 1300 hp

1 x KOHLER 19 kw

1 x KOHLER 9 kw

Cruising Speed: 20 knots

Fuel Consumption: 350 Litres/Hr

WATERSPORTS

Tenders + Toys: Tender with outboard engine 3,5 m and 15 hp

Waverunner SeaDoo 2 pax 90 hp

Wakeboard

Water skis

Towable tube

2 x kayaks

Snorkelling gear

LAYOUT

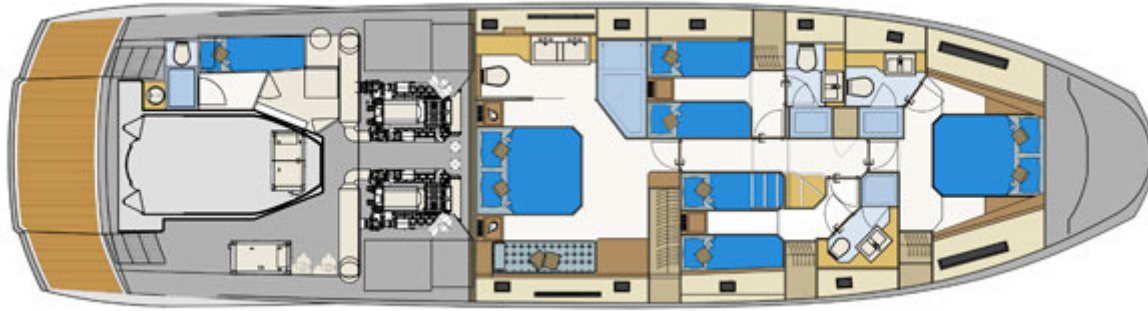

M 1963 N C A D A

Moncada Yachts
Passeig Sagrera 3 1ºB
Spain, Palma de Mallorca, 07012
Tel: +34 971684055
charter@moncadayb.com
www.moncadayb.com/

Disclaimer

This document is not contractual. All specifications are given in good faith and offered for informational purposes only. The publisher and company do not warrant or assume any legal liability or responsibility for the accuracy, completeness, or usefulness of any information and/or images displayed. Yacht inventory, specifications and charter prices are subject to change without prior notice. None of the text and/or images used in this brochure may be reproduced without written consent from the publisher.