

MONCADA CALA DI LUNA

1963



CALA DI LUNA

Length: 22.30 metres (73' 2")

Beam: 5.66 metres (18' 7")

Draft: 1.7 metres (5' 7")

Number of Guests: 8

Number of Crew: 3

Built: 2010

Refit: 2018

Builder: Sunseeker

Flag: British

Hull Construction: GRP

Hull Configuration: Displacement

Air conditioning, Stabilisers at anchor, Stabilisers underway, WiFi connection on board

CALA DI LUNA is probably one of the most versatile yachts in the Balearic islands; she blends comfort, speed and amazing amenities all into one. 3 decks built and finished with exquisite materials, which along with a superb distribution make CALA DI LUNA unique. She has four very well equipped double cabins all with en-suite facilities and is able to sleep up to 8 guests during night while 12 guests can be on board during the day. Her separated crew area guarantee the guests privacy at all times. It is worth highlighting the flybridge refit, including a wet-bar personalized with teppanyaki grill, two ice-makers and a bigger dining area, conformed by a wonderful sofa and

a huge table, aimed to comfortably seat 12 people, to enjoy tasteful meals while socialising, both during night and day; especially, when using the top hydraulic Bimini, equipped with LED lights. Other remarkable features are: Fin stabilizers that provide further comfort, both at anchor and cruising. Two wide solariums, one in the flybridge and another one in the bow, with adjustable backrests. A hydraulic platform, which among other benefits improves elder people's access to the yacht after a refreshing swim. CALA DI LUNA is based in Ibiza and available for Charter in the Balearic Islands.

KEY FEATURES

- 1** Berth in the exclusive VIP area of Marina Ibiza next to the famous restaurant Lío
- 2** Fin stabilizers that provide further comfort, both at anchor & cruising
- 3** A hydraulic platform, which among other benefits, improves the elderly access to the yacht after a refreshing swim
- 4** Fully equipped flybridge with wet-bar, personalized with Teppanyaki, two ice makers, a fabulous lounge area & a large dining table fit for 12 guests
- 5** Capacity at night for 8 guests in 4 ensuite cabins, 3 of them double



CALA DI LUNA - At anchor



CALA DI LUNA - At anchor



CALA DI LUNA - At anchor



CALA DI LUNA - Flybridge



CALA DI LUNA - Salon



CALA DI LUNA -Living room dining detail



CALA DI LUNA - Master Cabin



CALA DI LUNA - Master Cabin



CALA DI LUNA - Flybridge Teppanyaki detail



CALA DI LUNA - Flybridge solarium



CALA DI LUNA - Aft main deck



CALA DI LUNA - Aft main deck



CALA DI LUNA - Bow solarium



CALA DI LUNA - Master bathroom



CALA DI LUNA - VIP cabin



CALA DI LUNA - Twin cabin convertible to double



CALA DI LUNA - Twin cabin converted to double



CALA DI LUNA - Bunk cabin

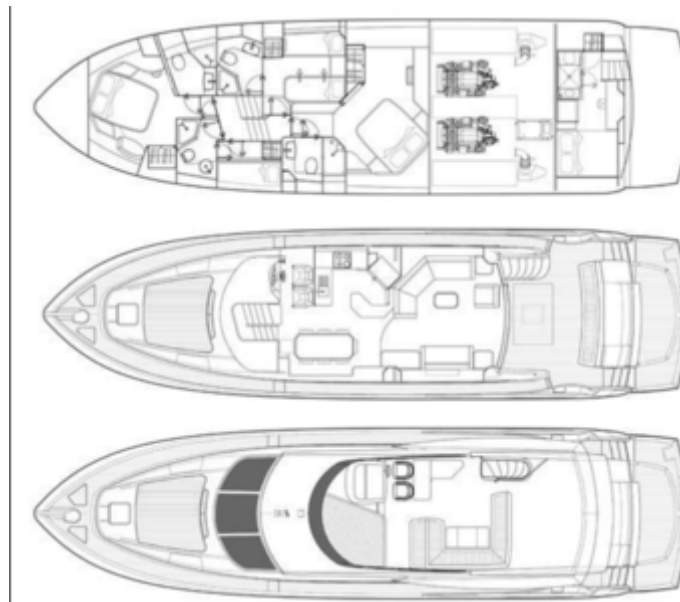

CALA DI LUNA - Layout

SPECIFICATIONS

ACCOMMODATION

Number of Guests: 8

Number of Cabins: 4

Cabin Configuration: 1 Double, 2 Twin, 1 Convertible

Bed Configuration: 2 Pullman, 2 Double, 2 Single

EQUIPMENT

Engines: 2 x MAN V12 1360 hp

1 x Kohler

Cruising Speed: 20 knots

Fuel Consumption: 340 Litres/Hr

WATERSPORTS

Tenders + Toys: Fin stabilizers (Side Power) at anchor and cruising

Tender Williams sportjet 395 90hp (new 2020)

Towable tube for 3 pax

Water skis

2 x paddle surf

3 x SeaDoo seascooter

Snorkelling gear

LAYOUT

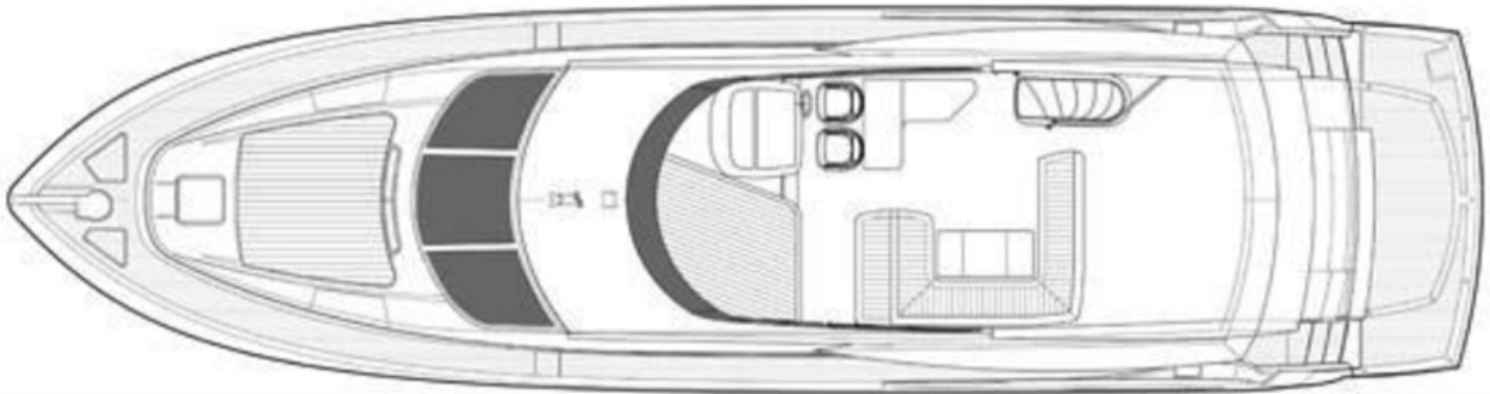
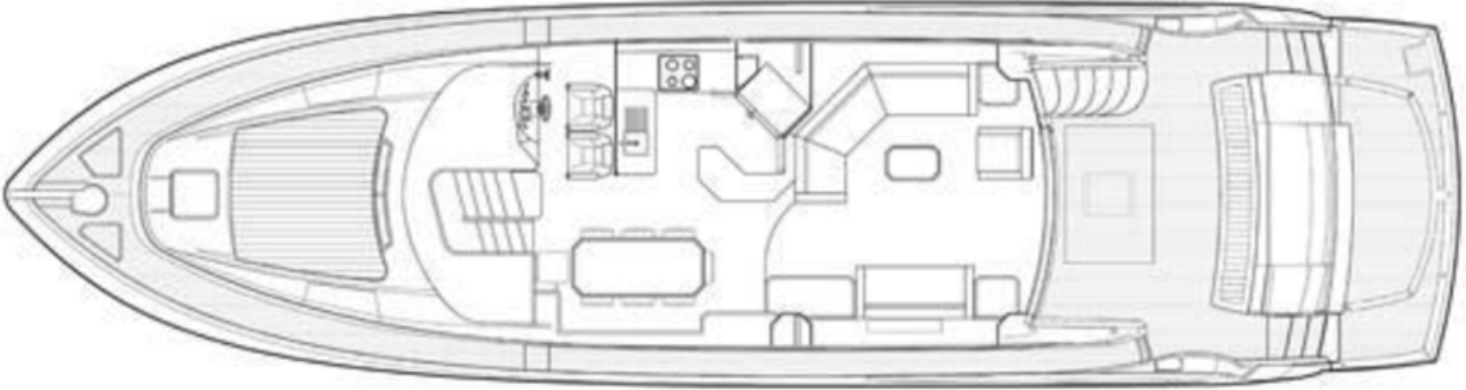

M 1963 N C A D A

Moncada Yachts
Passeig Sagrera 3 1ºB
Spain, Palma de Mallorca, 07012
Tel: +34 971684055
charter@moncadayb.com
www.moncadayb.com/

Disclaimer

This document is not contractual. All specifications are given in good faith and offered for informational purposes only. The publisher and company do not warrant or assume any legal liability or responsibility for the accuracy, completeness, or usefulness of any information and/or images displayed. Yacht inventory, specifications and charter prices are subject to change without prior notice. None of the text and/or images used in this brochure may be reproduced without written consent from the publisher.